

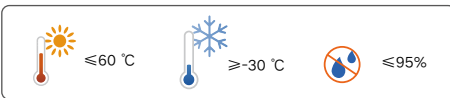

1 Installation Environment



2 Installation

- For communication over WLAN



- For communication over LAN

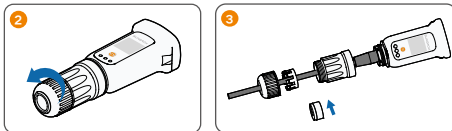
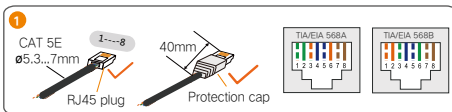

- Install iSolarCloud App and View the User Manual



3 Indicators and Multi-function Button

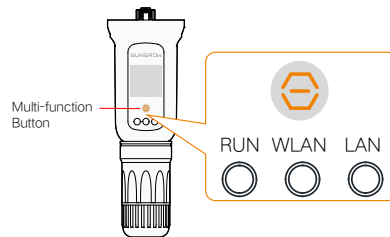

- Indicator Description

Indicator	Status	Description
RUN	Off	Not connected to external power supply
	Blinking green	Normal operation
	Steady red	Module failure
WLAN	Off	No data communication
	On	WLAN connected but no data communication
	Slow blink	Data communication
LAN	Fast blink	EasyConnect mode (factory default)
	Off	No data communication
	Steady green	Ethernet connected but no data communication
	Steady green, blinking red	Data communication

Multi-function Button Description

Operation	Description
Press once	Turn on/off EasyConnect mode
Press 3 times	Turn on WLAN hotspot. By default it requires no password to access within 30 minutes. It only turns on WLAN hotspot and does not turn it off.
Press and hold for 5s	Restore factory default

4 Connecting to iSolarCloud

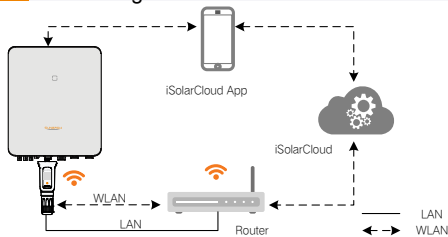

Connecting to iSolarCloud over LAN

Connect the module to the home router with a network cable. Check if the home router is assigned a static IP. If so, configure the static IP through the built-in Web. For instructions on how to configure, refer to the built-in Web.

Connecting to iSolarCloud over WLAN

- Configure EasyConnect for the module through iSolarCloud App.
- Configure network for the module through the built-in Web.

Network configuration

- Configure network through iSolarCloud App. Both general network configuration and EasyConnect configuration can be achieved over WLAN. For detailed instructions, refer to the chapter "Creating Plant" in the iSolarCloud App User Manual. The iSolarCloud App User Manual can be viewed by scanning the QR code in the chapter "2 Installation".
- To configure network through the built-in Web, do the following:
 - 1) Connect your PC to the WLAN hotspot named "SG-module serial number".
 - 2) Enter 11.11.11.1 in the address bar of the browser. Enter username "admin" and default password "pw8888" to log in the built-in Web.





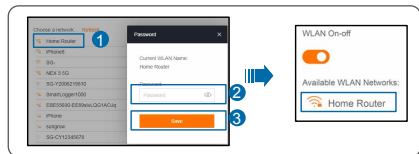





- 3) Click "System-> Port Parameter ->WLAN." Find the home router network in the list of available WLAN networks nearby.
- 4) Click the home router network and enter the password to connect to it.
- 5) When the icon  in the lower left corner lights up, network configuration is successful.



5 Performance Parameters

Nameplate

SUNGROW		Wireless Communication Module	
Model	WiNet-S		
S/N			
DC-Input	5.0V \pm 2.1A		
Enclosure	IP66		
Temperature	-30°C...+60°C		
			
Made in China		SUNGROW POWER SUPPLY CO., LTD.	

Parameter	Description
DC-Input	--- : Direct current
Enclosure	Dustproof and waterproof rating IP66: The product is completely dustproof and can withstand waves of water and pressurized jets, causing no harm.
Temperature	Operating temperature range
	Do not dispose of the communication module together with household waste
	CE mark of conformity
	Refer to the corresponding instructions

Wireless Transmit Power

Mode	TRP
802.11b	≤ 20 dBm
802.11n HT20	≤ 14 dBm

Wireless Operating Frequency

Parameter	Value
Operating frequency	2412 MHz - 2472 MHz

6 Troubleshooting

If the module fails to be connected to the iSolarCloud, troubleshoot as follows:

No.	Fault	Corrective Measure
1	WLAN indicator is off	Check, through the iSolarCloud App or the built-in Web, if the module is connected to the home router.
2	WLAN indicator blinks fast	Check, through the iSolarCloud App, if the module is connected to the home router.
3	WLAN indicator is on for more than 1min	<ol style="list-style-type: none"> 1) Check and ensure that the home router can access the network normally. 2) Check the whitelist/blacklist settings of the home router. Add the iSolarCloud network to the whitelist or remove it from the blacklist when necessary. iSolarCloud website: api.isolarcloud.com , api.isolarcloud.com.hk , api.isolarcloud.eu <ol style="list-style-type: none"> 3) Check the home router settings and ensure that the port 19999 is not blocked. 4) If the fault still persists, contact SUNGROW.
4	LAN indicator is off	<ol style="list-style-type: none"> 1) Check and ensure that the network cable is securely connected to the module and the home router. 2) Replace the network cable and repeat the previous step.
5	LAN indicator is on for more than 1min	Method 1: <ol style="list-style-type: none"> 1) Check if the home router is assigned a static IP. If so, configure the static IP through the built-in Web. 2) Replace the network cable and repeat the previous step. Method 2: Refer to the corrective measure to No. 3.